



Polyester enclosures

Description

Polyester enclosures have proven their worth in many industrial plants. They offer safe protection even when they are used under extremely unfavorable conditions, on exposure to aggressive chemical media or hard mechanical conditions. The inside base of the enclosure has at its sides, threaded bushings for the fastening of mounting rails or panels. The enclosure is mounted by means of insulated screws outside of the lid seal.

Features

- Chemical-resistant
- Temperature-resistant
- Flame-retardant
- Use in Ex areas with a surface resistance <math>< 10^9 \Omega</math>, black enclosure
- Corrosion-proof
- Seawater-proof

Explosion protection

Ex protection type

Ex enclosure **black** 07-5185-..../....

ATEX II 2G Ex e IIC Gb
 II 2D Ex tb IIIC Db IP 66

Certification

PTB 08 ATEX 1064

IECEX Ex e IIC Gb

Ex tb IIIC Db IP 66

Certification

PTB 09.0009X

Ex enclosure **grey** 07-5184-..../....

ATEX II 2G Ex e IIC Gb

Certification

PTB 08 ATEX 1064

IECEX Ex e IIC Gb

Certification

PTB 09.0009X

Other approvals and certificates, see www.bartec-group.com

Technical data

Material

glass-fiber reinforced polyester, EN 60079-0
 halogen-free
 black surface resistance <math>< 10^9 \Omega</math>
 grey surface resistance >math>> 10^{12} \Omega</math>

Colour

black RAL 9005
 grey RAL 7000/RAL 7001

Lid screws (other models on request)

stainless steel cross-head (+ -)

Standard seal

EPDM -20 °C to +95 °C
 optional
 Silicone -55 °C to +100 °C

Mechanical resistance (EN 60079-0)

impact energy 7 Nm

Protection class EN 60529/IEC 60529

IP 66

Selection chart

Empty enclosure

External dimensions in mm Length (L) x Width (B) x Height (H)	Polyester black, IP 66/67 ➔ Order no.	Polyester grey, IP 66/67 ➔ Order no.
80 x 75 x 55	07-5195-0800/7555	07-5194-0800/7555
110 x 75 x 55	07-5195-1100/7555	07-5194-1100/7555
160 x 75 x 55	07-5195-1600/7555	07-5194-1600/7555
190 x 75 x 55	07-5195-1900/7555	07-5194-1900/7555
122 x 120 x 90	07-5195-1221/2090	07-5194-1221/2090
122 x 120 x 120	07-5195-1221/2012	07-5194-1221/2012
220 x 120 x 90	07-5195-2201/2090	07-5194-2201/2090
160 x 160 x 90	07-5195-1601/6090	07-5194-1601/6090
160 x 160 x 120	07-5195-1601/6012	07-5194-1601/6012
260 x 160 x 90	07-5195-2601/6090	07-5194-2601/6090
360 x 160 x 90	07-5195-3601/6090	07-5194-3601/6090
560 x 160 x 90	07-5195-5601/6090	07-5194-5601/6090
200 x 250 x 120	07-5195-2002/5012	07-5194-2002/5012
255 x 250 x 120	07-5195-2552/5012	07-5194-2552/5012
255 x 250 x 160	07-5195-2552/5016	07-5194-2552/5016
400 x 250 x 120	07-5195-4002/5012	07-5194-4002/5012
400 x 250 x 160	07-5195-4002/5016	07-5194-4002/5016
400 x 405 x 120	07-5195-4004/0512	07-5194-4004/0512
400 x 405 x 165	07-5195-4004/0516	07-5194-4004/0516
600 x 250 x 120	07-5195-6002/0512	07-5194-6002/0512



Dimensions (mm)

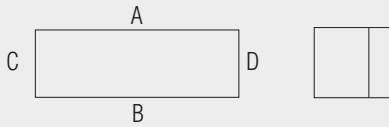

The dimensions indicated on this page apply to the following polyester enclosures and distribution boxes:

<i>IP enclosure</i>	<i>black</i>	<i>07-5195-.../...</i>	<i>Ex e distribution box</i>	<i>black</i>	<i>07-5103-.../...</i>
<i>IP enclosure</i>	<i>grey</i>	<i>07-5194-.../...</i>	<i>Ex e distribution box</i>	<i>grey</i>	<i>07-5106-.../...</i>
<i>Ex enclosure</i>	<i>black</i>	<i>07-5185-.../...</i>	<i>Ex i distribution box</i>	<i>black</i>	<i>07-5105-.../...</i>
<i>Ex enclosure</i>	<i>grey</i>	<i>07-5184-.../...</i>	<i>Ex i distribution box</i>	<i>grey</i>	<i>07-5107-.../...</i>
<i>IP distribution box</i>	<i>black</i>	<i>07-5178-.../...</i>			
<i>IP distribution box</i>	<i>grey</i>	<i>07-5177-.../...</i>			

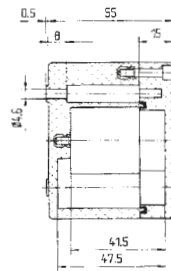
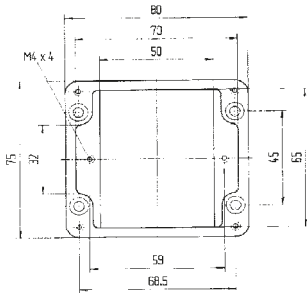

➔ Technical data

External dimensions: 80 x 75 x 55 mm

Weight: 230 g
Material: polyester, grey, black
Article no.: 07-51 [] -0800/7555

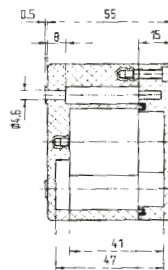
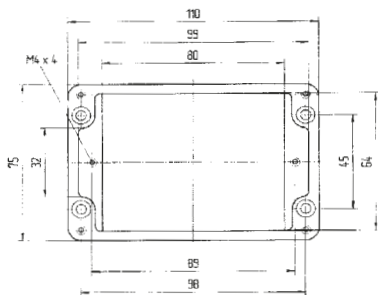

External dimensions: 110 x 75 x 55 mm

Weight: 280 g
Material: polyester, grey, black
Article no.: 07-51 [] -1100/7555

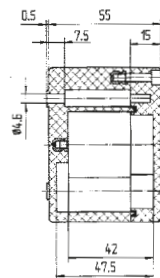
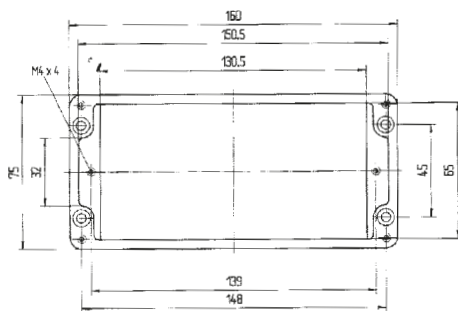

External dimensions: 160 x 75 x 55 mm

Weight: 370 g
Material: polyester, grey, black
Article no.: 07-51 [] -1600/7555

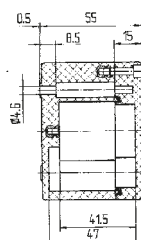
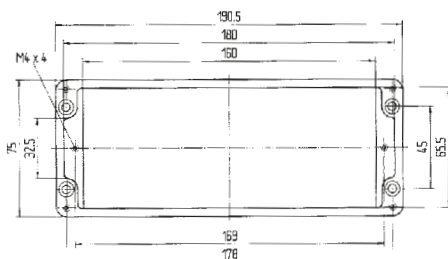

External dimensions: 190 x 75 x 55 mm

Weight: 430 g
Material: polyester, grey, black
Article no.: 07-51 [] -1900/7555



Dimensions (mm)

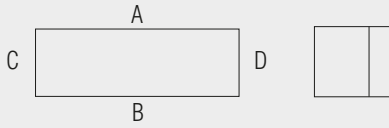

The dimensions indicated on this page apply to the following polyester enclosures and distribution boxes:

<i>IP enclosure</i>	<i>black</i>	<i>07-5195-.../...</i>	<i>Ex e distribution box</i>	<i>black</i>	<i>07-5103-.../...</i>
<i>IP enclosure</i>	<i>grey</i>	<i>07-5194-.../...</i>	<i>Ex e distribution box</i>	<i>grey</i>	<i>07-5106-.../...</i>
<i>Ex enclosure</i>	<i>black</i>	<i>07-5185-.../...</i>	<i>Ex i distribution box</i>	<i>black</i>	<i>07-5105-.../...</i>
<i>Ex enclosure</i>	<i>grey</i>	<i>07-5184-.../...</i>	<i>Ex i distribution box</i>	<i>grey</i>	<i>07-5107-.../...</i>
<i>IP distribution box</i>	<i>black</i>	<i>07-5178-.../...</i>			
<i>IP distribution box</i>	<i>grey</i>	<i>07-5177-.../...</i>			

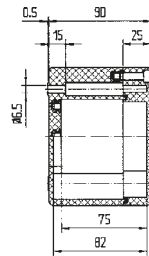
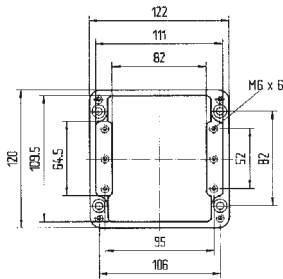

➔ Technical data

External dimensions: 122 x 120 x 90 mm

Weight: 660 g
 Material: polyester, grey, black
 Article no.: 07-51 -1221/2090

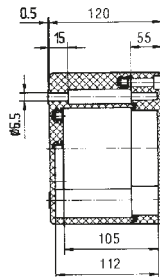
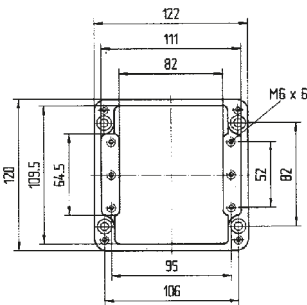

External dimensions: 122 x 120 x 120 mm

Weight: 890 g
 Material: polyester, grey, black
 Article no.: 07-51 -1221/2012

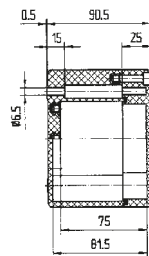
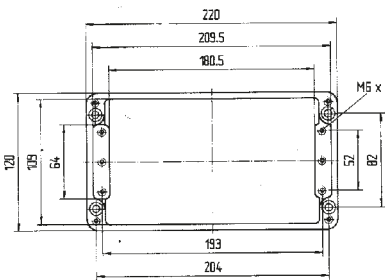

External dimensions: 220 x 120 x 90 mm

Weight: 1040 g
 Material: polyester, grey, black
 Article no.: 07-51 -2201/2090

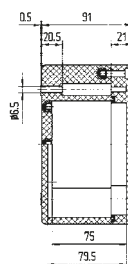
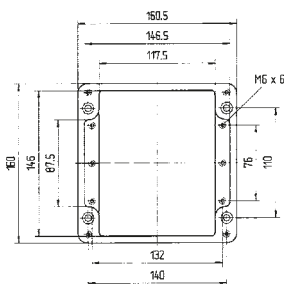

External dimensions: 160 x 160 x 90 mm

Weight: 1280 g
 Material: polyester, grey, black
 Article no.: 07-51 -1601/6090



Dimensions (mm)

The dimensions indicated on this page apply to the following polyester enclosures and distribution boxes:

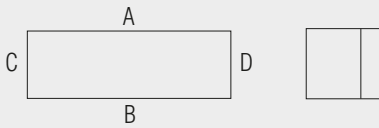

<i>IP enclosure</i>	<i>black</i>	<i>07-5195-.../...</i>	<i>Ex e distribution box</i>	<i>black</i>	<i>07-5103-.../...</i>
<i>IP enclosure</i>	<i>grey</i>	<i>07-5194-.../...</i>	<i>Ex e distribution box</i>	<i>grey</i>	<i>07-5106-.../...</i>
<i>Ex enclosure</i>	<i>black</i>	<i>07-5185-.../...</i>	<i>Ex i distribution box</i>	<i>black</i>	<i>07-5105-.../...</i>
<i>Ex enclosure</i>	<i>grey</i>	<i>07-5184-.../...</i>	<i>Ex i distribution box</i>	<i>grey</i>	<i>07-5107-.../...</i>
<i>IP distribution box</i>	<i>black</i>	<i>07-5178-.../...</i>			
<i>IP distribution box</i>	<i>grey</i>	<i>07-5177-.../...</i>			

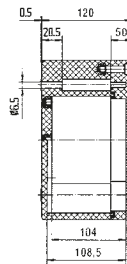
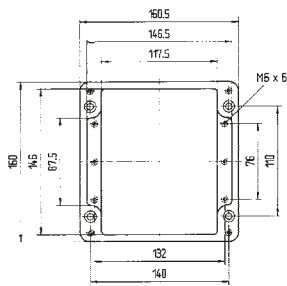

Technical data

External dimensions: 160 x 160 x 120 mm

Weight: 1500 g
 Material: polyester, grey, black
 Article no.: 07-51 -1601/6012

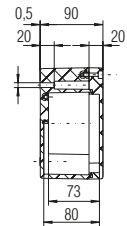
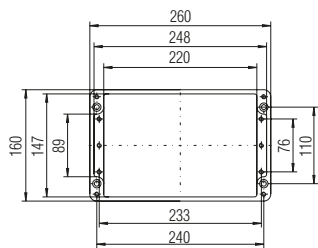

External dimensions: 260 x 160 x 90 mm

Weight: 1750 g
 Material: polyester, grey, black
 Article no.: 07-51 -2601/6090

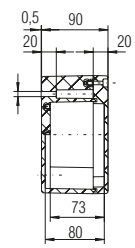
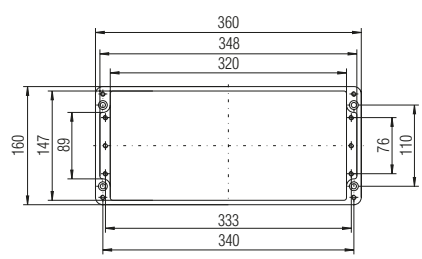

External dimensions: 360 x 160 x 90 mm

Weight: 2300 g
 Material: polyester, grey, black
 Article no.: 07-51 -3601/6090

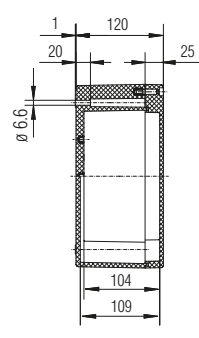
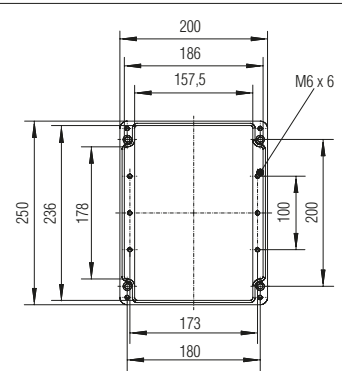

External dimensions: 200 x 250 x 120 mm

Weight: 2320 g
 Material: polyester, grey, black
 Article no.: 07-51 -2552/5012



Dimensions (mm)

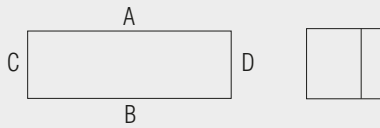

The dimensions indicated on this page apply to the following polyester enclosures and distribution boxes:

<i>IP enclosure</i>	<i>black</i>	<i>07-5195-.../...</i>	<i>Ex e distribution box</i>	<i>black</i>	<i>07-5103-.../...</i>
<i>IP enclosure</i>	<i>grey</i>	<i>07-5194-.../...</i>	<i>Ex e distribution box</i>	<i>grey</i>	<i>07-5106-.../...</i>
<i>Ex enclosure</i>	<i>black</i>	<i>07-5185-.../...</i>	<i>Ex i distribution box</i>	<i>black</i>	<i>07-5105-.../...</i>
<i>Ex enclosure</i>	<i>grey</i>	<i>07-5184-.../...</i>	<i>Ex i distribution box</i>	<i>grey</i>	<i>07-5107-.../...</i>
<i>IP distribution box</i>	<i>black</i>	<i>07-5178-.../...</i>			
<i>IP distribution box</i>	<i>grey</i>	<i>07-5177-.../...</i>			

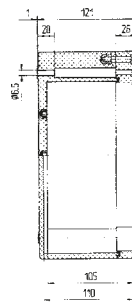
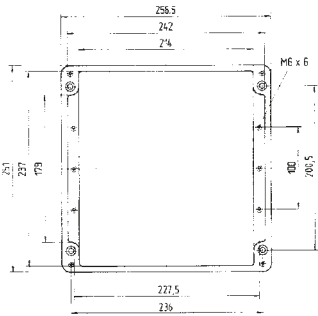

➔ Technical data

External dimensions: 255 x 250 x 120 mm

Weight: 2730 g
 Material: polyester, grey, black
 Article no.: 07-51 -2552/5012

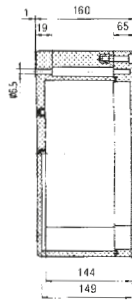
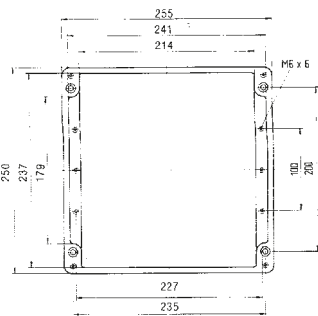

External dimensions: 255 x 250 x 160 mm

Weight: 3275 g
 Material: polyester, grey, black
 Article no.: 07-51 -2552/5016

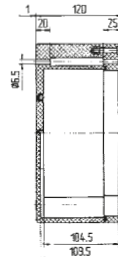
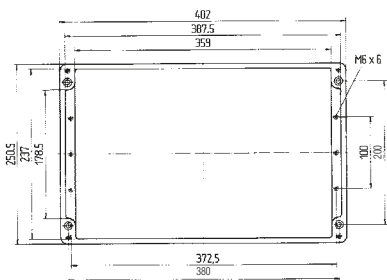

External dimensions: 400 x 250 x 120 mm

Weight: 3650 g
 Material: polyester, grey, black
 Article no.: 07-51 -4002/5012

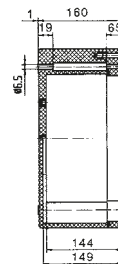
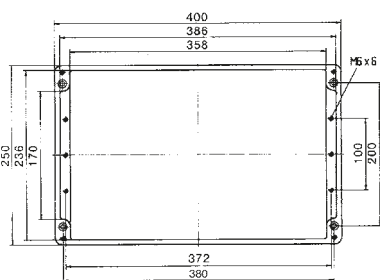

External dimensions: 400 x 250 x 160 mm

Weight: 4800 g
 Material: polyester, grey, black
 Article no.: 07-51 -4002/5016



Dimensions (mm)

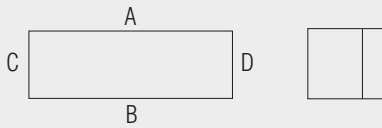

The dimensions indicated on this page apply to the following polyester enclosures and distribution boxes:

<i>IP enclosure</i>	<i>black</i>	<i>07-5195-.../...</i>	<i>Ex e distribution box</i>	<i>black</i>	<i>07-5103-.../...</i>
<i>IP enclosure</i>	<i>grey</i>	<i>07-5194-.../...</i>	<i>Ex e distribution box</i>	<i>grey</i>	<i>07-5106-.../...</i>
<i>Ex enclosure</i>	<i>black</i>	<i>07-5185-.../...</i>	<i>Ex i distribution box</i>	<i>black</i>	<i>07-5105-.../...</i>
<i>Ex enclosure</i>	<i>grey</i>	<i>07-5184-.../...</i>	<i>Ex i distribution box</i>	<i>grey</i>	<i>07-5107-.../...</i>
<i>IP distribution box</i>	<i>black</i>	<i>07-5178-.../...</i>			
<i>IP distribution box</i>	<i>grey</i>	<i>07-5177-.../...</i>			

➤ Technical data

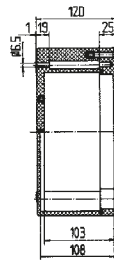
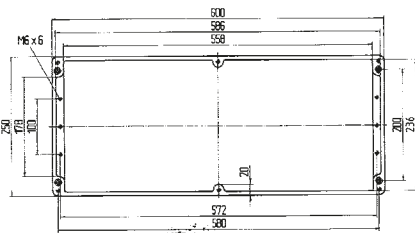

External dimensions: 600 x 250 x 120 mm

Weight: 5380 g
 Material: polyester, grey, black
 Article no.: 07-51 -6002/5012

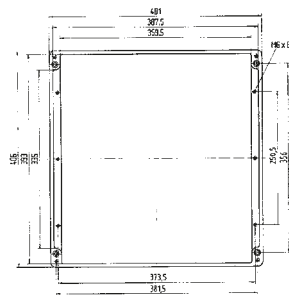

External dimensions: 400 x 405 x 120 mm

Weight: 5080 g
 Material: polyester, grey, black
 Article no.: 07-51 -4004/0512

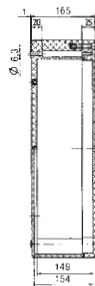
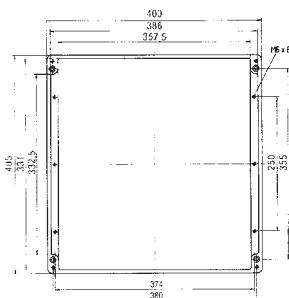

External dimensions: 400 x 405 x 165 mm

Weight: 7740 g
 Material: polyester, grey, black
 Article no.: 07-51 -4004/0516

All dimensions are approximate measurements and subject to technical changes.