

The relay modules offer most up-to-date switching configurations. A suppressor diode on the coil protects the power circuit from peak voltages. The relay is used to switch power circuits up to 6 A. Thanks to its low power consumption it can be controlled by means of electronic circuits, optorelays from BARTEC or standard control circuits.

Explosion protection

Marking ATEX	II 2G Ex db e IIC Gb II M2 Ex db e I Mb
Certification	PTB 97 ATEX 1068 U
Marking IECEx	Ex db e IIC Gb Ex db e I Mb
Certification	IECEx PTB 11.0083U
Marking CSA	Class I, Zone 1, IIC A/Ex d e IIC Gb
Certification	CSA 2011-2484303U
Other approvals and certificates, see www.bartec.de	

Technical data

Enclosure material	High-quality thermoplastic	
Protection class	Module	IP 66 EN/IEC 60529
	Terminals	IP 20 EN/IEC 60529
Terminals	2.5 mm ² , fine stranded	
Mounting rail	TH 35 x 7.5 (15) EN/IEC 60715	
Labelling	written marking labels	
Storage temperature	-40 °C to +70 °C	
Ambient temperature	-20 °C to +40 °C	
Weight	0.250 kg	

1

Dimensions/mounting positions

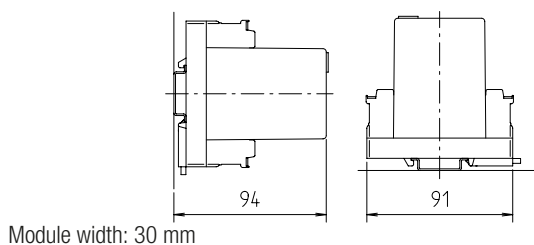

Wiring diagram 1/terminal assignment 1

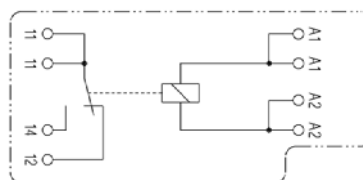

Wiring diagram 2/terminal assignment 1

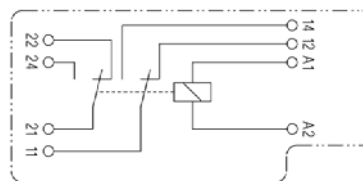



Electrical data

Coil data				
AC/DC 12 V	AC/DC 24 V	AC 110 V	AC 120 V	AC 230/240 V
± 10 %	± 10 %	+10 %	+10 %/60 Hz	+ 10 %
0.45 W	0.46 W	1.2 VA	1.0 VA	1.2 VA
0.6 VA	0.56 VA			
Making current (16 ms)	20 A (1 changeover contact) 10 A (2 changeover contacts)			
Test voltage	Coil-contact 4 kV			
Mechanical life	> 20 x 10 ⁶ switching cycles			
Electrical life	> 1 x 10 ⁵ switching cycles/AC 230 V 6 A ohmic load (1 changeover contact) > 1 x 10 ⁵ switching cycles/AC 230 V 3 A ohmic load (2 changeover contacts)			
Operating frequency	1800 switching cycles/h			

Contact data Contact material AgCdO

U _A	I _{max.}	P _{max.}	(1 changeover contact)	
AC 400 V	2,0 A	700 VA	}	cos φ = 1
AC 250 V	6.0 A	1400 VA		ohmic load
DC 125 V	0.6 A	75 W	}	cos φ = 1
DC 50 V	3.0 A	150 W		ohmic load
U _A	I _{max.}	P _{max.}	(2 changeover contacts)	
AC 400 V		1.0 A 350 VA	}	cos φ = 1
AC 250 V		3.0 A 700 VA		ohmic load
DC 125 V		0.25 A 30 W	}	cos φ = 1
DC 50 V		1.5 A 75 W		ohmic load

Ordering information

Contacts	Code no.	Voltage	Code no.
1 changeover	1	AC/DC 12 V	2
		AC/DC 24 V	3
2 changeovers	2	AC 110 V	7
		AC 120 V/60 Hz	H
		AC 230 V/240 V	9

Complete order no. 07-7311-937 / **000**

Relay, 2 changeover contacts also available in AC/DC 48 V.

Order no. 07-7311-9372/4000

Please insert correct code. Technical data subject to change without notice.