

Sector Electronic-Data-Processing

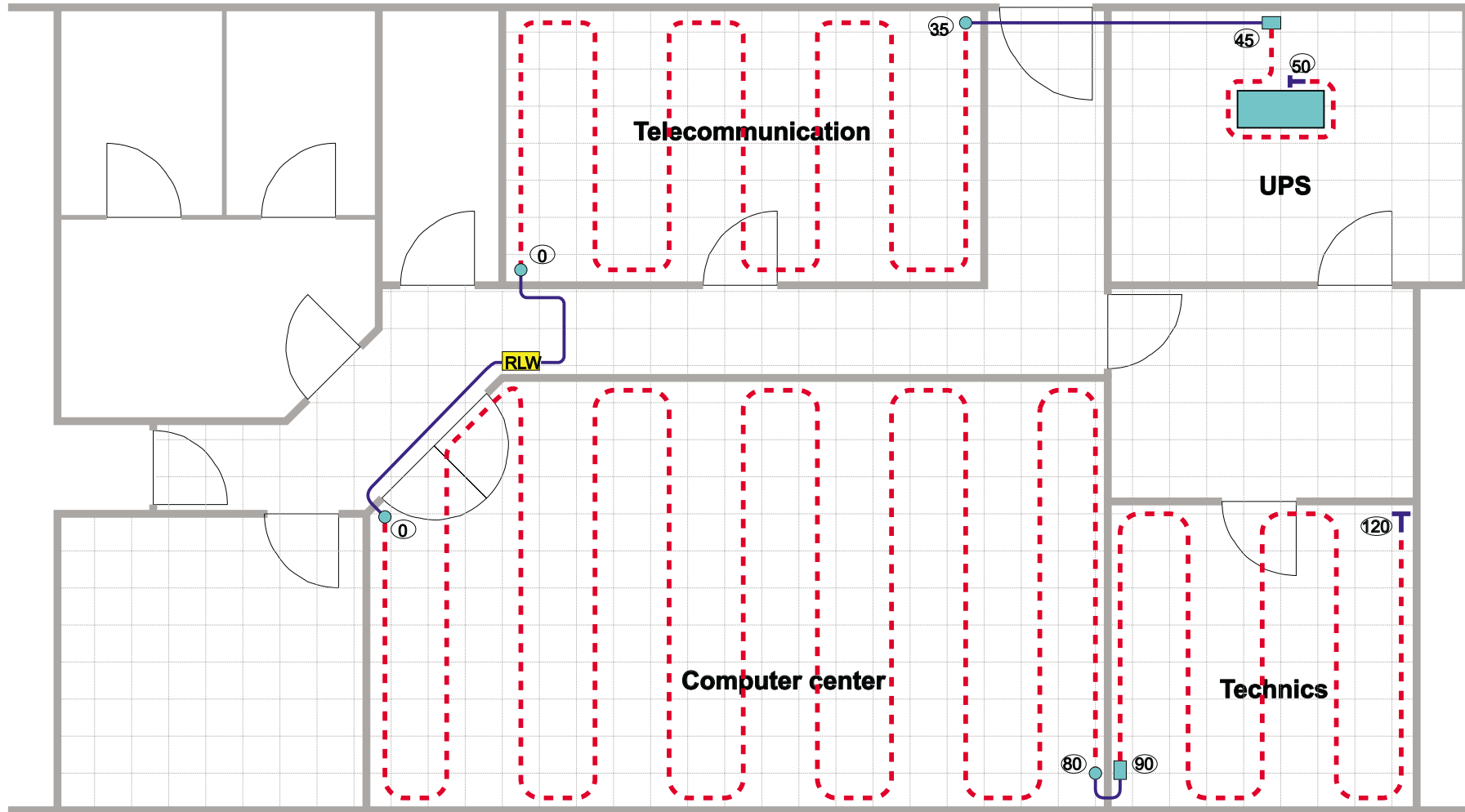

BARTEC Monitoring Systems

Max-Eyth-Straße 16 • D-97980 Bad Mergentheim •
Tel.: +49 7931/597-0 • Fax.: +49 7931/597-183

Water warning systems for leakage detection of fluids

- | | | | |
|--------------------|-------------------------|------------------|-------------------|
| Plug-in connection | Zone separation 10 m | Connection cable | Aircondition |
| End plug | Leakage reference point | Sensor cable | Monitoring device |

CUSTOMER'S NAME

WaterWarningSystem RLW with sensor cable SCR

Instructions for flush-mounting in walls

The zone separation module provides a very good partition of leakage detection between two rooms. The offset of the zone separation (10 m) has to be taken into account in the installation plan (see drawing).

Example: 50 m sensor cable in room 1 and 30 m sensor cable in room 2.
That means 80 m total sensor length + 10 m zone separation.
The monitoring device observes 90 m.
The connection cable doesn't influence the length.

A room description can also be stored in addition to the metre readout. This is done with the menu "canal zone".

Zone 1: 0 to 50 m text: e.g. EDP-Room 1
Zone 2: 60 to 90 m text: e.g. EDP-Room 2

Up to 50 zones can be realized.

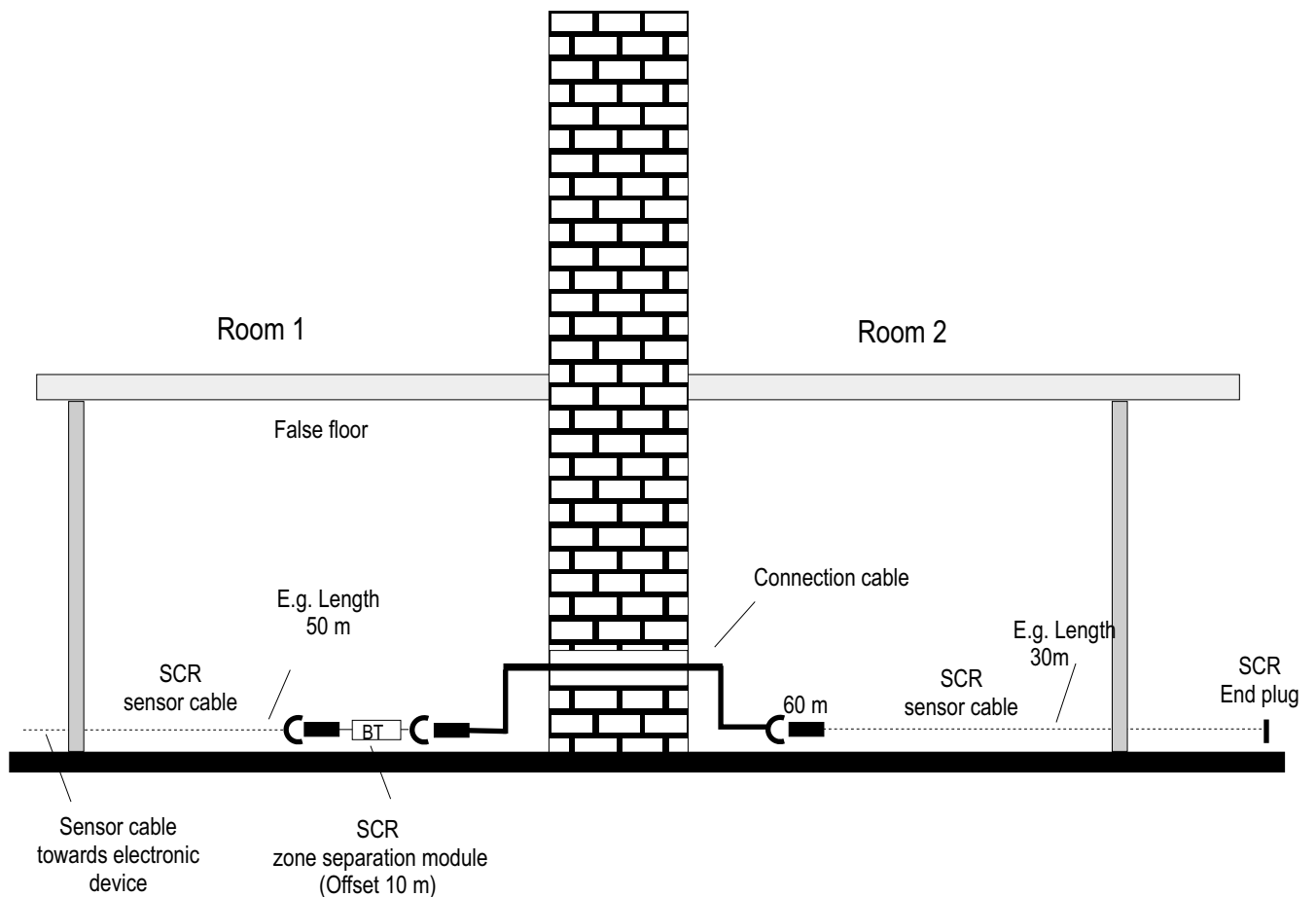

WaterWarningSystem with localization

Example of connection: sensor cable SCR with T-joint

Type: 17-85Z4-3200

Applications:

- Arm within a line of sensor cable
- separation between rooms and floors

In the T-joint integrated is a zone separation. This guarantees exact identification of rooms and floors. The connection cable doesn't influence information on leak localization.

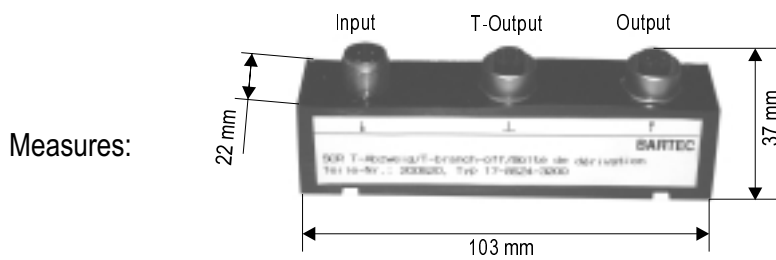

Example:

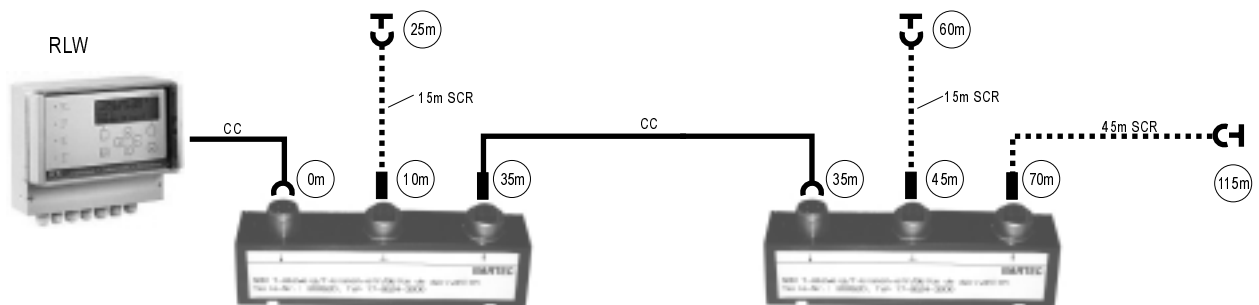

Function zone separation

10m sensor cable are simulated between input and T-output
and
10m sensor cable are simulated between T-output and output.

The additional length is registered by the monitoring device RLW.

Legend:

RLW	Monitoring device
SCR	Sensor cable
CC	Connctection cable
Xm	Point of reference in meter
+	End plug
—	4 pin plug
⊖	4 pin socket