



Fuse max. 6.3 A, quick-acting

BARTEC



Fuse

Description

With the increase in automated functions and processes, it is necessary to install common protective systems on site. Fuse elements are required to protect equipment and circuits also in hazardous areas. MODEX fuse elements are advantageous as they are in explosion-proof encapsulation and installed in an enclosure with integrated double terminals.

Dimensions/mounting positions

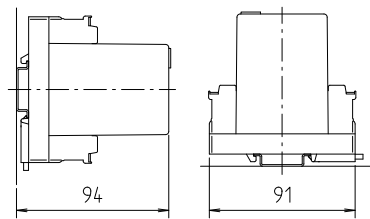

Module width: 30 mm

Wiring diagram/terminal assignment

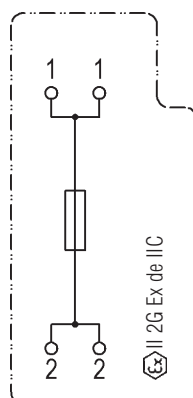

Explosion protection

Ex protection type

- II 2G Ex de IIC
- I M2 Ex de I

Certification

PTB 97 ATEX 1068 U

Technical data

Enclosure material

High-quality thermoplastic

Protection class

Module IP 66/IEC 60529
Terminals IP 20/IEC 60529

Terminals

2.5 mm², fine stranded

Mounting rail

TH 35 x 7.5 (15) DIN EN 60715

Terminal designation

written marking labels

Storage temperature

-40 °C to +70 °C

Ambient temperature

-20 °C to +40 °C

Weight

0.250 kg

Electrical data see selection chart

Rated voltage

250 V

Switching capacity

at 250 V, 50 Hz, cos φ = 1
35 A for to 3.15 A
40 A for 4 A
63 A for 6.3 A

Guidelines/norms/certifications

Directive 94/9/EC

Selection chart

Nominal current	Code no.	Characteristic	Code no.
2.5 A	L	quick-acting	F
4.0 A	N		
6.3 A	Q		

➔ **07-7311-93J2 / 00**

Complete order no.

Please enter code number.

Technical data subject to change without notice.