



Fuse max. 6.3 A

BARTEC



Fuse

Description

Fused modules are required to protect equipment and circuits in hazardous areas. With the increasing automation of functions and processes requires the installation of the standard protective devices on-site. An advantage of MODEX fuses is that they are fitted in flameproof enclosures with integrated double terminals. This allows the input and output voltage to be used by other MODEX component too.

Dimensions/mounting positions

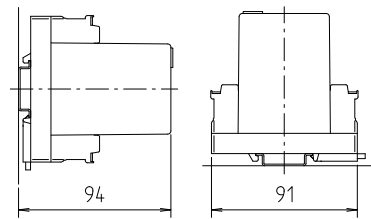

Module width: 30 mm

Wiring diagram/terminal assignment

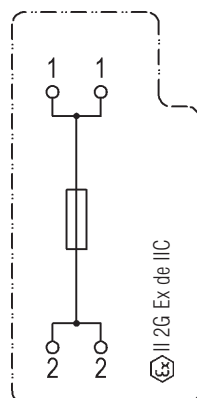

Explosion protection

Ex protection type

- Ex II 2G Ex de IIC
- Ex I M2 Ex de I

Certification

PTB 97 ATEX 1068 U

Technical data

Enclosure material

High-quality thermoplastic

Protection class

Module IP 66/IEC 60529
Terminals IP 20/IEC 60529

Terminals

2.5 mm², stranded

Mounting rail

TH 35 x 7.5 (15) DIN EN 60715

Terminal designation

written marking labels

Storage temperature

-40 °C to +70 °C

Ambient temperature

-20 °C to +40 °C

Weight

0.250 kg

Electrical data see selection chart

Nominal voltage

250 V

Switching capacity

at 250 V, 50 Hz, cos φ = 1
1000 A for (M) 3.15 A to 6.3 A
35 A for (T) to 3.15 A
40 A for (T) 4 A
50 A for (T) 5 A
63 A for (T) 6.3 A

Guidelines/norms/certifications

Directive 94/9/EC

Selection chart

Nominal current	Code no.	Characteristic	Code no.
3.15 A	M	time lag	T
4.0 A	N		
5.0 A	P	medium time lag	M
6.3 A	Q		

➔ **07-7311-93J2/** **00**
Complete order no.

Please enter code number.

Technical data subject to change without notice.